



WANJIA

Relays for advanced technology

POWER RELAY

WJ173-RELAYS

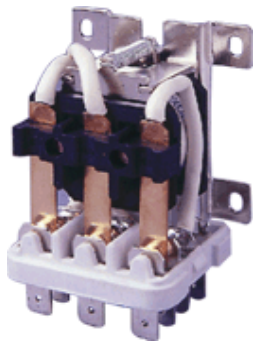

- Small size and light weight.
- Low coil power consumption.
- High contact load.
- Strong anti-shock high reliability.

SPECIFICATIONS

Contact

Arrangement	3A, 3B, 3C
Contact Material	Silver alloy
Contact Resistance (By voltage drop 6V 1A)	Max.50mΩ
Rating Nominal switching capacity Resistive load	30A 250VAC 30A 28VDC
Max. Switching Voltage	28VDC/250VAC
Max. Switching Current	30A
Max. Switching Power	7500VA/840W
Expected life (min. ope) Mechanical(at 120 cpm) Electrical (at 20 cpm)	1×10 ⁷ 1×10 ⁵

Characteristics

Operate Time	Max. 20msec.	
Release Time	Max. 15msec.	
Initial breakdown voltage Between coil & contact Between open contacts	2000VAC (50/60Hz) for 1 min. 1500VAC (50/60Hz) for 1 min.	
Insulation Resistance	Min. 100MΩ (500 VDC)	
Ambient temperature	-40°C ~ +70°C	
Operating humidity	45 to 85% RH	
Shock Resistance	Functional	Min. 10G
	Destruction	Min. 100G
Vibration Resistance	Functional	10 to 55 Hz at double Amplitude of 1.5mm
	Destruction	10 to 55 Hz at double Amplitude of 1.5mm
Unit weight	Approx.120g	

COIL DATE

Coil Consumption	sensitive: 3.8VA/2.5W
Coil Voltage (1pole)	6 - 110VDC
Coil Voltage (2pole)	6 - 240VAC
Coil Resistance	see COIL SPECIFICATION below

UL/C-UL Rating

Resistive load (cosφ=1)	
Inductive load (cosφ=0.75 - 0.8)	

COIL SPECIFICATION (at 20°C)

Type	Nominal Voltage (VDC) (VAC)	Coil Resistance (Ω)	Nominal operating power (W)	Pick-up Voltage	Drop-out Max. Allowable Voltage	
AC	6	2.5	abt. 3.8VA (50 - 60Hz)	75% Max.	30% Min.	120%
	12	10				
	24	40				
	36	89				
	110	840				
	220	3340				
DC	6	15	abt. 2.5W	75% Max.	10% Min.	120%
	12	56				
	24	230				
	36	500				
	48	920				
	60	1440				
	110	4700				

Quality policy:

Today's quality is our future market;
Our goal is pursuing Vendor satisfaction.

Environmental policy:

Keeping the system safe, Abiding by laws;
Innovation in technology, Prevention of pollution;
Advertising & education, Continuous improvement.

WJ173-1Pole Plug terminal

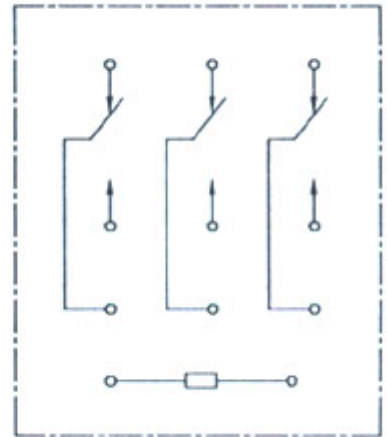
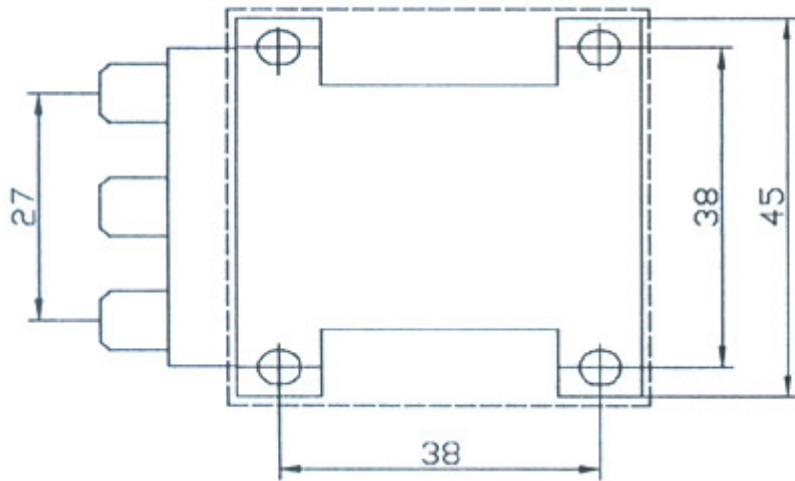

WJ173-3Pole Plug terminal

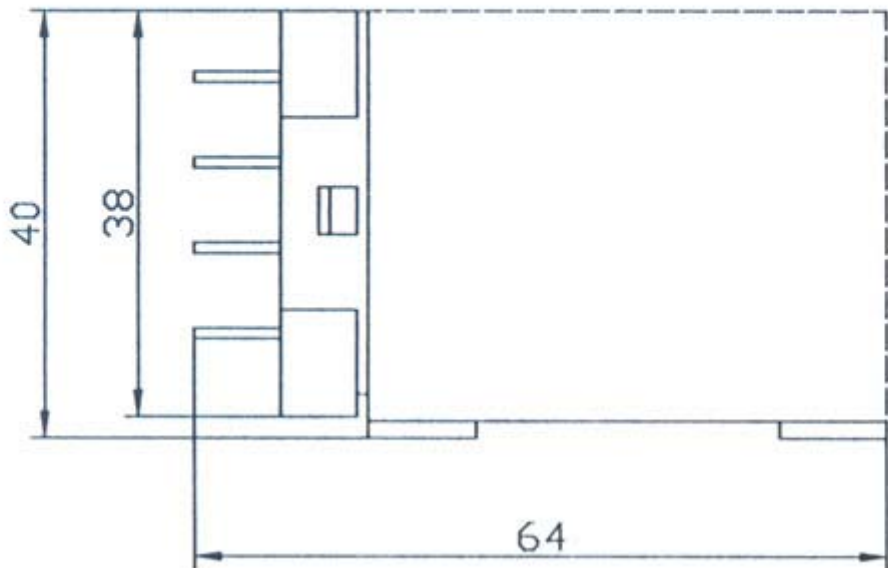

Quality policy:

Today's quality is our future market;
Our goal is pursuing Vendor satisfaction.

Environmental policy:

Keeping the system safe, Abiding by laws;
Innovation in technology, Prevention of pollution;
Advertising & education, Continuous improvement.